

BEGIN PROJECT  
H-172311B

US 23 / US 74  
(GREAT SMOKY MOUNTAINS EXPY.)

ROSEMOUNT RD.

BLUE RIDGE PARKWAY

US 23 / US 74  
(GREAT SMOKY MOUNTAINS EXPY.)

BLUE RIDGE SOUTHERN RAILROAD

MATCHLINE SEE ROLL 2

PROPOSED  
GUIDERAIL

TIE TO EXISTING  
GUARDRAIL

RANGER LANE

SR 1701  
(CANDLE STICK LANE.)

SR 1717  
(BALSAM VIEW DR.)

HAYWOOD COUNTY  
JACKSON COUNTY

THE FOLLOWING ITEMS ARE BEING  
CONSTRUCTED AS PART OF THE  
H-172311A (BRP INTERCHANGE) PROJECT:  
- WB RIGHT TURN LANE ONTO BRP  
- WB ACCELERATION LANE FROM BRP  
- DOUBLE FACED GUARDRAIL TO CLOSE  
MEDIAN CROSSOVER  
- RANGER LANE FROM EB US 23 TO BRP

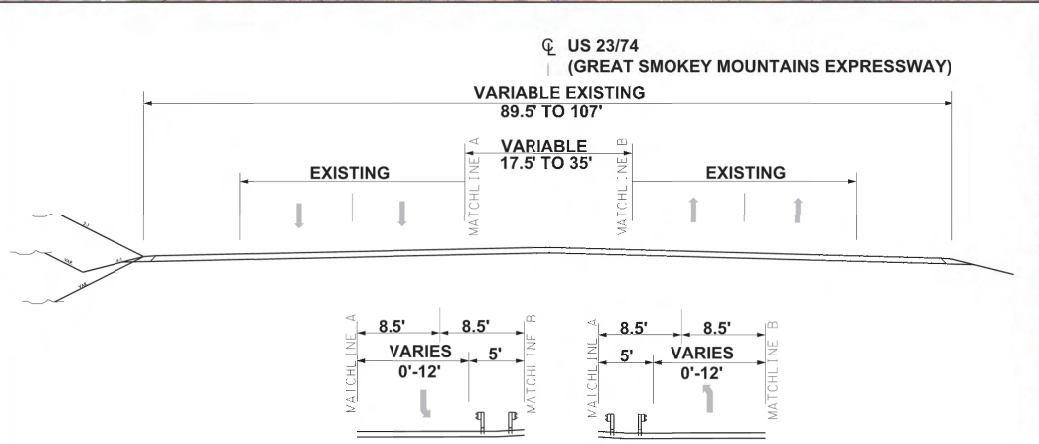

**FEASIBILITY MAP**  
PROJECT H-172311B  
**JACKSON & HAYWOOD COUNTIES**  
US 23/74 (GREAT SMOKY MOUNTAINS EXPY)  
ACCESS MANAGEMENT

ROLL 1 OF 1

**SCALE: 1" = 100'**



JACKSON COUNTY  
HAYWOOD COUNTY

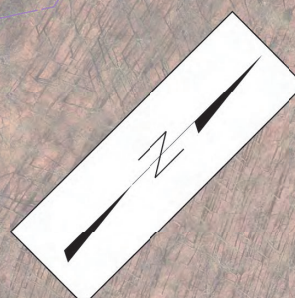

MATCHLINE SEE ROLL 1

PROPOSED  
MEDIAN  
GUIDERAIL

BLUE RIDGE SOUTHERN RAILROAD

US 23 / US 74  
(GREAT SMOKY MOUNTAINS EXPY)

MATCHLINE SEE ROLL 3

BLUE RIDGE SOUTHERN RAILROAD

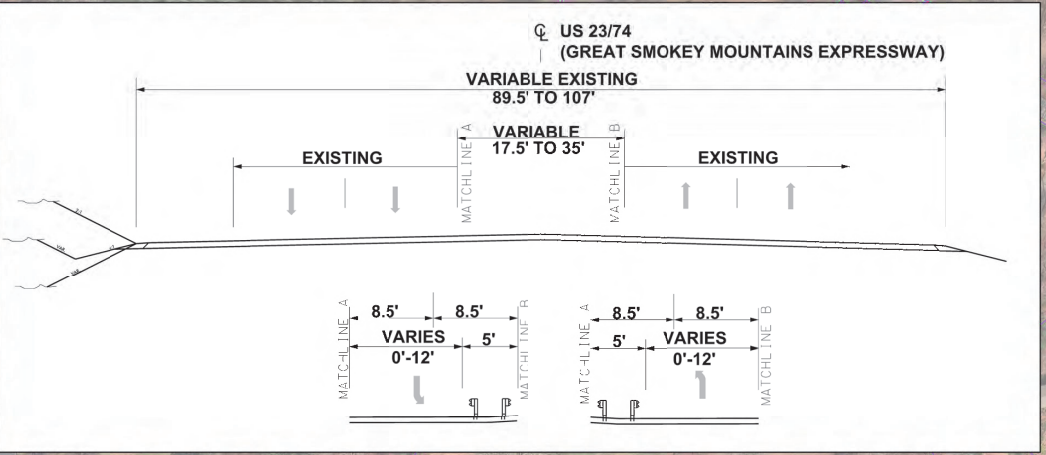

**FEASIBILITY MAP**  
PROJECT H-172311B  
**JACKSON & HAYWOOD COUNTIES**  
US 23/74 (GREAT SMOKY MOUNTAINS EXPY)  
ACCESS MANAGEMENT

ROLL 2 OF 4  
**SCALE: 1" = 100'**



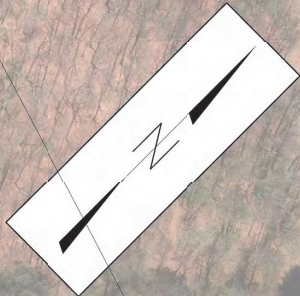

MATCHLINE SEE ROLL 2

US 23 / US 74  
(GREAT SMOKY MOUNTAINS EXPY)

REST AREA

RED BANK ROAD

MATCHLINE SEE ROLL 4

REPLACE EXISTING ISLAND

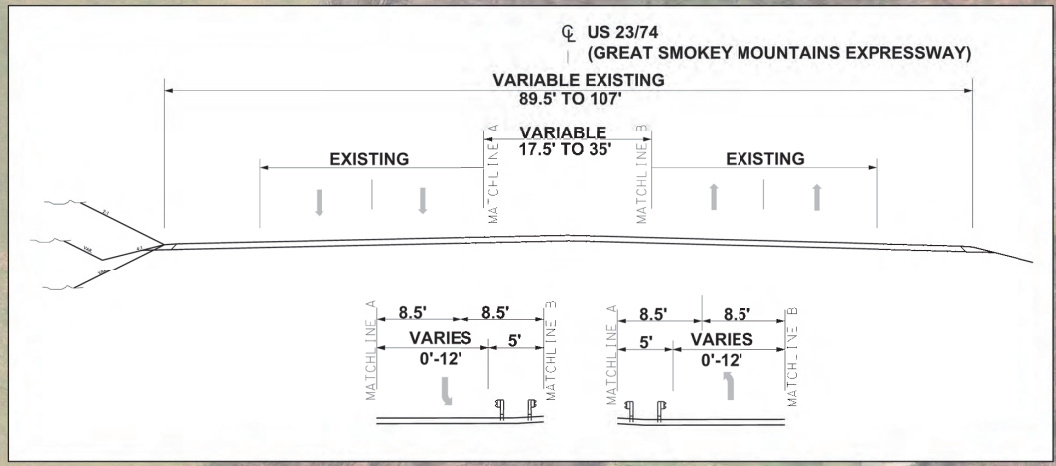

**FEASIBILITY MAP**  
PROJECT H-172311B  
**JACKSON & HAYWOOD COUNTIES**  
US 23/74 (GREAT SMOKY MOUNTAINS EXPY)  
S ACCESS MANAGEMENT

ROLL 3 OF 4

**SCALE: 1" = 100'**



